



The shelter house was donated to the park by the East Chain Sportsmen's Club.

This is the first park in the County system. The County Board of Commissioners accepted the Holy Family Subdivision Park and dedicated it for public use as a park and access to East Chain Lake. There are approximately two acres of land in the park, a shelter house, playground equipment, lake access, swimming, fishing, picnicking. The shelter house was donated to the park by the East Chain Sportsmen's Club.

### WOLTER PARK



This property was acquired by the County park system in 1968 when the road was changed and the land given to the county. This is a small park with boat landing access to Iowa Lake, good shore fishing and picnicking.

### KLESSIG PARK



The largest county park is located north of Trimont on Cedar Lake and the original Cedar Lake Park consisted of 43 acres. The Edwin Dushinske farm was sold to the County in 1971 to create Cedar Lake County Park and included timber and a peninsula jutting out into Cedar Lake. This property has approximately one mile of shoreline, and is located on the north side of the lake. Later the Hanson Memorial Park was added and is now known as Cedar Hanson Park. Hanson Park was originally the John Hanson farm and had been a local gathering place for many years. After Hanson's death, the property became a community park. The park features 20 modern camp sites with water and electrical hook-ups along with a variety of primitive campsites.



The property where Timberlane Park is currently located had been divided into woodlot parcels in the early part of the century. This property was purchased in 1966 from Mary Sargent by the Martin County Conservation Club and by the County in 1971. The southeast side was owned by the Girl Scouts from the 1930s to 1970. In 1968 the State bought 5.4 acres for a DNR-maintained boat landing and dock to provide public access to South Silver Lake. Timberlane Park is an ideal area to hike, view wildlife and numerous native plants.

### TIMBERLANE PARK

The property where Timberlane Park is currently located had been divided into woodlot parcels in the early part of the century. This property was purchased in 1966 from Mary Sargent by the Martin County Conservation Club and by the County in 1971. The southeast side was owned by the Girl Scouts from the 1930s to 1970. In 1968 the State bought 5.4 acres for a DNR-maintained boat landing and dock to provide public access to South Silver Lake. Timberlane Park is an ideal area to hike, view wildlife and numerous native plants.

This property became part of the Martin County Conservation Club in the late 1960's and was purchased by the County in 1971. In the early 1800s remains were found from Fort Tchan Hassen, a fur-trading post of the John Jacob Astor American Fur Company. This lake was originally called Babcock for James H. Babcock, the first settler on the southwest end of the lake. He named the lake Bright Lake, although settlers of the time still called the lake Babcock. For many years, there was rookery for the night herons on the south shore of the lake. Bright Lake is one of the largest lakes in the west chain of lakes. Bright Lake is linked to Clayton Lake by Perry Lake which is one the smallest lakes in the County. This is shallow and marshy and sometimes dry. Bright Lake Park is a primitive park with few amenities, a good park to hike, enjoy wildlife and nature.

### BRIGHT LAKE PARK

## MARTIN COUNTY PARKS

Martin County invites you to visit our beautiful local parks. Whichever park you prefer, enjoy your visit and respect what the county maintains for all its residents.



"Take only pictures, leave only footprints."



The park features 9 modern camp sites with water and electrical hook-ups along with a variety of primitive campsites.

Previously pasture land, this park was purchased from the Truman JCs in 1971. This is a well-developed park with RV and tent camping. There is a variety of playground equipment, from swings to horseshoe pits. Hiking the trails and steep banks to the lake offer viewing of wildlife and natural vegetation. The park features 9 modern camp sites with water and electrical hook-ups along with a variety of primitive campsites.

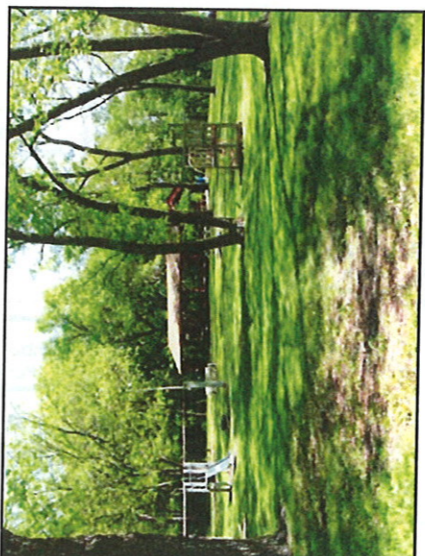

### PERCH LAKE PARK

### A BRIEF HISTORY OF OUR PARKS

Early Martin County was home to native American Dakota, Ojoe and Iowa tribes as well as fur traders, soldiers, hunters and voyagers. In 1856 the first white settlers came to Martin County. The land on which our parks are located is rich with many stories and legends about these early peoples and how they lived and hunted.

In 1971, with funds from the Land and Water Conservation fund of the U.S. Dept. of Interior, the State of Minnesota (the State Grant program) and Martin County, the county park system was put in place. The first four parks purchased were Perch Lake Park near Truman, Cedar Lake Park near Trimont, Bright Lake Park near Ceylon and Timberlane Park on South Silver and Iowa Lakes. Wolter Park was given to the county by the Holy Family Catholic Church.

Initially these parks were to be developed and maintained by community and service groups close to the respective parks, with local plans complementary to the county park plan. The original federal, state and county money could only be used for land acquisition and not development. In 1975, concerns about vandalism and disrepair in the parks led to a park maintenance program and a county park board. There are over 230 acres of county park land in Martin County. Each park has its own unique characteristics. There are well-developed parks: Perch Lake Park and Cedar Hanson Park; small parks: Klessig Park and Wolter Park; and parks which are natural and primitive: Bright Lake Park and Timberlane Park. All of the parks are adjacent to a lake.

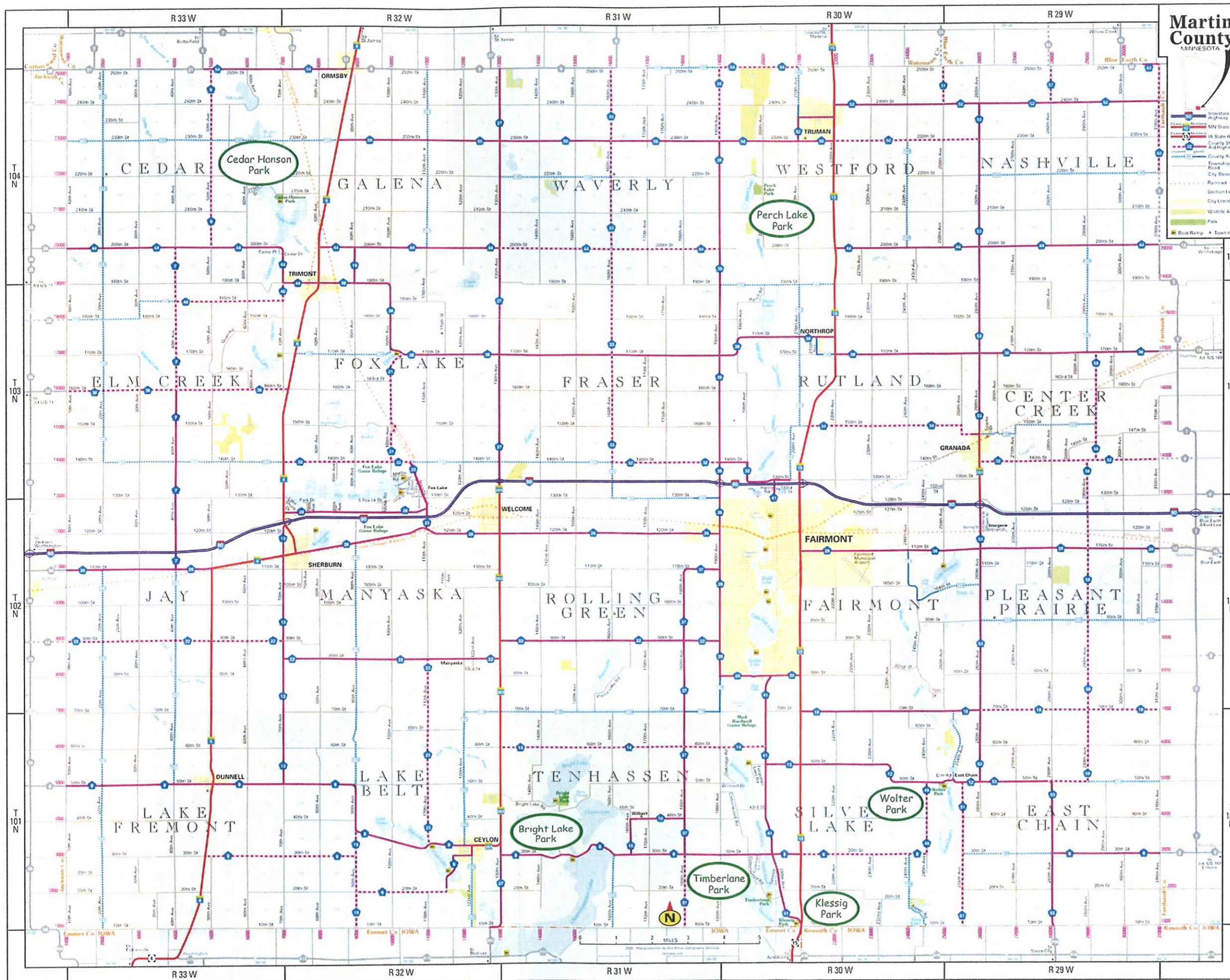

**Martin County**  
MINNESOTA

Legend:

- Highway
- State Highway
- County State Highway
- County Road
- Township Road
- City Street
- Railroad
- Section Line
- City Limits
- Waste Area
- Park
- Boat Ramp
- Town Hall

AMENITIES	CEDAR HANSON PARK	PERCH LAKE PARK	BRIGHT LAKE PARK	TIMBERLANE PARK	KLESSIG PARK	WOLTER PARK
ELECTRICAL / WATER CAMPING SITES	●	●				
PRIMITIVE CAMPING SITES	●	●	●			
HIKING / BIKING TRAILS	●	●	●	●		
HORSEBACK RIDING TRAILS	●	●	●	●		
PLAYGROUND EQUIPMENT	●	●				●
FIRE WOOD AVAILABLE	●	●				
BEACH	●				●	●
SHELTER HOUSE	●	●	●		●	●
PICNIC TABLES	●	●	●	●	●	●
FIRE PITS	●	●	●	●	●	●
FISHING PIER	●	●		●	●	●
BOAT LAUNCH	●		●	●	●	●
RESTROOMS (flush)		●				
RESTROOMS (pit)	●		●	●	●	●
SHOWERS		●				
DUMP STATION	●					

**GENERAL PARK INFORMATION**

Follow all park rules posted at the parks.

Shelter houses can be reserved for special occasions by calling the Martin County Auditor/Treasurer's office at (507) 238-3211.